

SoftTrans™

DigitalPaper™
CLC Transfer Paper for Light Garments



- 

Laser Paper
- 

Inkjet Paper
- 

Wide Format
- 

**A3✓
A4✓**
- ✓ Cotton
✓ Polyester
✓ Cotton Poly Blends**

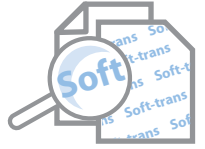

Before you start!

- Avoid touching the printable surface of the paper as this will effect the toners bond.
- Print on the plain side NOT the blue printed branded side.
- Use SoftTrans on oil finished Colour Lazer Copiers only.
- SoftTrans is suitable for white and very light garment.
- Use EvolutionCLC™ for dark garments.



Code: RELEASEPAPER

How to Print on SoftTrans™

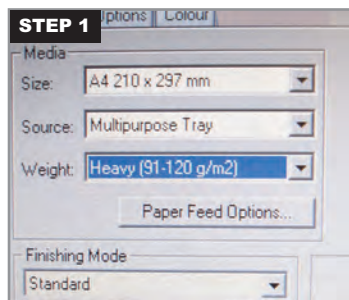

STEP 1
Set your Colour Laser Printer to "Heavy Stock"



STEP 2
Lay your SoftTrans plain side up in the manual feed tray



STEP 3
Print "Mirror Image"

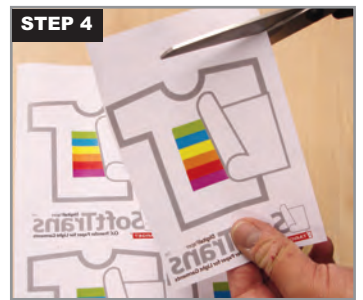

STEP 4
On finished print trim away excess paper from each individual image.

Application Instruction



STEP 1
Pre press garment for 10 seconds at 190°C to disperse any creases or moisture.



STEP 2
Lay your print image down so that you can see the SoftTrans back print and cover with release paper.



STEP 3
Apply for 12 seconds at 190°C using very firm/heavy pressure. Then peel hot.

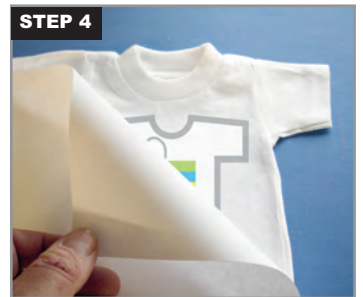

STEP 4
Re cover with plain copier paper to seal the image for another 10 seconds and then peel hot.

Take care when washing!



For best results turn the garment inside out and use a colour detergent during washing.

Call NOW!
01376 326 351
RE ORDER TODAY

www.TargetTransfers.com | 01376 326351

Target Transfers, Anglia Way, Braintree, Essex CM7 3RG. Fax: 01376 345876

TARGET®
Creating the Right Image™

Exclusive Distributor
in the UK & Ireland of
STAHL'S
PRODUCTS